

## INTRODUCTION

JaguarVoice provides a safe and convenient way of controlling the following vehicle systems:

- Sound system (radio, single CD player and CD changer – as applicable).
- In-car telephone.
- Climate control system (front user only unless - zone climate control is fitted).

The system is controlled by the Voice button on the left-hand side of the steering wheel.

See the illustrations on the following pages.



### **WARNING:**

**Concentrate on the current road conditions and driving the vehicle at all times. If the voice system does prompt you for a response it will repeat that prompt twice giving you up to 15 seconds to respond. If driving conditions mean that you are unable to respond, the voice system will time-out, cancel the task and will not make any changes to the vehicle settings.**

---

### **Language and accent**

Commands are given in English using a natural speaking voice, without pausing between words. Most accents are understood without difficulty, but the system also allows you to train the voice system with your voice if required, see '*VOICE TRAINING*', page 322.

# JaguarVoice

## Steering wheel voice switches

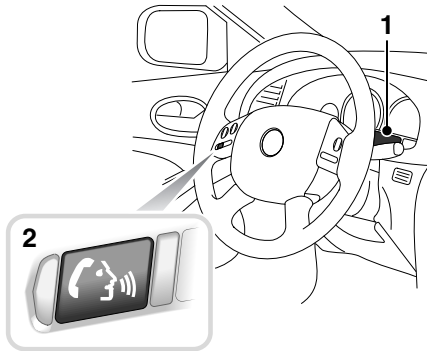

- JAG0825
1. Message centre display.
  2. Voice button.
  3. Mode button, on radio.
  4. Seek/tuning control, on radio (used to commence voice training).

## USING THE SYSTEM

### Initialisation

JaguarVoice is ready to operate ten seconds after the starter switch is turned to position II; the system is enabled.

### Driver voice controls

The voice button is on the left-hand side of the steering wheel, see 'Steering wheel voice switches', page 312.

Some examples of using the system are provided on the following pages for you to try.

**Note:** The system will not operate until the radio security code has been entered.

First try some of the following commands:

# JaguarVoice

---

## Tuning the radio

Your instructions to the system	System response
Press and release the voice button	'Beep'
After the beep say ' <b>Radio tune 98.9 FM</b> '	The system responds with: 'Radio tune 98.9 FM' and tunes the radio to this frequency

Now try entering a frequency of your own preference, see '*HOW TO SAY NUMBERS*', page 317.

## Storing a nametag to this station

Your instructions to the system	System response
Press and release the voice button	'Beep'
After the beep say ' <b>Radio store name</b> '	The system responds with: 'Radio store name, Name Please'
Press and release the voice button	'Beep'
After the beep say ' <b>My favourite station</b> '	The system responds with: 'My favourite station, please say yes or no'
Press and release the voice button	'Beep'
After the beep say ' <b>Yes</b> '	After a few seconds the system responds with: 'My favourite station stored'

## Recalling the nametag you have just stored

Your instructions to the system	System response
Press and release the voice button	'Beep'
After the beep say ' <b>Radio tune my favourite station</b> '	The system responds with: 'Radio tune my favourite station' and tunes the radio to the frequency stored with this name

Now try storing a nametag of your choice, and then recalling it.

# JaguarVoice

---

## Entering a phone number

Your instructions to the system	System response
Press and release the voice button	'Beep'
After the beep say ' <b>Phone enter zero one six one four</b> '	The system responds with: 'Phone enter oh one six one four, ..... Continue entering digits or say dial, store, correction or cancel'
Press and release the voice button	'Beep'
After the beep say ' <b>nine six oh nine nine eight</b> '	The system responds with: nine six oh nine nine eight, ..... Continue entering digits or say dial, store, correction or cancel'
Press and release the voice button	'Beep'
After the beep say ' <b>Dial</b> '	The system responds with: 'Enter Dial'

Now try entering a phone number of your choice and try some of the following commands:

1. **DIAL**, dials the number entered.
2. **STORE**, stores a nametag of your choice (as in the above example with **Radio store name**).
3. **CORRECTION**, deletes the last string of digits entered, and allows you to re-enter them.
4. **CANCEL**, cancels the command.

**Note:** When entering a number of your choice, remember numbers can only be given as single digits, but you can enter the digits in as many groups as you like.

Also, when the system has read out the numbers you have entered, you do not have to wait for the 'Continue entering digits' prompt. Simply press the voice button and continue with your dialogue.

# JaguarVoice

---

## Operating tips

- After pressing the voice button, wait for the end of the single listening beep before giving the command. \* 'LISTENING' will be displayed on the instrument pack.
- Face forward and speak naturally, as if you were talking to a passenger or on the phone.
- Note the structure of the commands; remember this rather than trying to remember all the commands.

**Device      Function      Setting**



'Radio Tune 97.4'

- If you forget any of the commands, try saying 'VOICE HELP'. The system will then give you a list of help menus available, from which you can choose the appropriate one for the command you need.
- The Voice system will repeat the command back to you and display it on the message centre. The command will then be performed.
- If you hear a double beep when you give a command, press the voice button and try again. \*

\* A single beep denotes when the voice system is listening for a command. A double beep denotes when the system has stopped listening, due to an error or when an incorrect command has been given.

## Command confirmation

After a command has been given, the system will give feedback of what it understood. The verbal feedback can be switched on or off by saying 'VOICE FEEDBACK ON' or 'VOICE FEEDBACK OFF'. Verbal feedback for help commands, directory listings, prompts, error messages and nametags cannot be switched off.

For the 'PHONE DIAL' commands, the system will prompt for confirmation before making the call. This confirmation can be switched on or off by saying 'PHONE CONFIRMATION ON' or 'PHONE CONFIRMATION OFF.'

For each voice command there is an associated visual confirmation, which is shown on the front instrument pack.

## Voice system prompts

During some commands and for voice training, you will be asked by the system for a reply. In such cases you must press and release the voice button then speak after the beep. The system will remind you twice so don't worry about having to respond to the system immediately.

## Nametags

Nametags are a unique name or phrase of your choice which can be used to recall a radio station or dial a phone number.

For radio commands, 'PHONE DIAL <nametag>' is used to select a station that has been previously stored using the 'RADIO STORE NAME' command.

# JaguarVoice

---

For phone commands, 'RADIO TUNE <nametag>' is used to dial a phone number that has been previously stored using the 'PHONE ENTER' or 'PHONE STORE' command. Phone numbers held in the voice system memory are quite separate from numbers held in the phone system memory (To call a number held in the phone memory, use the 'PHONE DIAL MEMORY <number>' command).

A spoken list of current nametags can be heard by giving the appropriate directory command.

- 'RADIO DIRECTORY'
- 'PHONE DIRECTORY'

There are also commands for deleting either individual names in a directory, or a complete directory, see '*VOICE COMMAND LIST*', page 318.

## Hints on storing nametags

- You will have greater success of recalling, and remembering, nametags of two, three, or four words in length. Although nametags of one word in length are also acceptable.
- For best results, store nametags in a quiet environment, i.e. with the windows and sunroof closed, try not to be travelling at speeds above 100 km/h (60 mph), and ask other occupants to be quiet.
- Try not to store a nametag that sounds similar to a nametag already stored, or to any of the commands recognized by the system.

In addition, for phone nametags, do not use numbers, and for radio nametags, try not to use radio frequencies.

## Volume level adjustment

The verbal feedback volume level can be adjusted independently for the JaguarVoice system. To adjust, operate the sound system volume control or the steering wheel volume control whilst the voice system is being used. The speaker volume level can also be adjusted within the volume preset menu of the audio system.

## Some useful notes:

- Only one person at a time can use the voice system.
- Excessive noise, for example while driving with windows open or in demist mode, may cause voice command misrecognition. If it is too noisy to use the phone, it is likely that voice commands will not be recognised.
- Voice commands cannot be given while a hands-free phone call or radio traffic announcement is in progress.
- If the voice button is pressed whilst a radio traffic announcement is in progress, the announcement will be cancelled. Press the voice button again to start a voice session.
- While 'LISTENING' is displayed on the message centre, the command can be cancelled by pressing the same voice button that was used to start the voice session, except when using the 'PHONE ENTER' command. To cancel a 'PHONE ENTER' voice session either say 'CANCEL' when 'LISTENING' is displayed or press the voice button and after the end of the beep say 'CANCEL'. During a store nametag session, if the voice button is pressed and released during 'LISTENING', the system will cancel after up to two seconds.

# JaguarVoice

---

- Voice feedback can be interrupted by pressing the voice button that was used to start the voice session, whilst the feedback is playing.
- After starting to speak, the command must be completed within ten seconds.
- During a voice command the audio system and direction indicator ticking will be muted.
- The voice session will be cancelled if an alternative message requires the display/speaker (e.g. incoming phone call or radio traffic announcement).

## HOW TO SAY NUMBERS

Numbers in voice commands must be given as shown below. Either 'zero' or 'oh' can be used for '0', most users will find that 'zero' gives better results. For information about specific commands, see *'VOICE COMMAND LIST'*, page 318.

### Radio stations

Frequencies are said as in the following examples:

- 'Tune five thirty one AM', or 'Tune five thirty one' (531).
- 'Tune nine hundred' (900).
- 'Tune fourteen forty' (1440).
- 'Tune fifteen oh three AM' (1503).
- 'Tune ten eighty' (1080).
- 'Tune eighty nine point nine FM' or 'Tune eighty nine point nine' (89.9).
- 'Tune ninety point zero' or 'Tune ninety' (90.0).
- 'Tune one hundred point five' (100.5)
- 'Tune one oh one point one FM' (101.1).
- 'Tune one oh eight point oh', 'Tune one oh eight point zero', or 'Tune one oh eight' (108.0).

### Disc and track numbers

For CD commands, say disc and track numbers as in the following examples:

- 'Disc one' (1).
- 'Disc six track ten' (6, 10).
- 'Track twenty five' (25).
- 'Track forty seven' (47).

# JaguarVoice

---

## Phone numbers

All phone numbers are said as single digits, as in the following example. Double, Triple and Treble are also acceptable commands if preceding a single digit. Plus (+), Star (\*) and Hash (#) are acceptable as the first digit of a number.

- 'Dial zero one two zero three four zero two one double four' (01203 402144).

When using the Phone Enter command, the first entry must be between 2 –16 digits, then, 1 – 16 digits to a maximum of 32 in total.

## Temperatures

In climate control commands, say temperatures as in the following examples:

- 'Temperature seventy two' (72).
- 'Temperature eighty' (80).
- 'Temperature twenty one point five' (21.5).
- 'Temperature nineteen point zero', 'Temperature nineteen point oh' or 'Temperature nineteen' (19.0).

## VOICE COMMAND LIST

Certain commands are only available to the driver, these are indicated in the following list.

### Key

( ) denotes an option, i.e. (ON/OFF) use either ON or OFF with this command.

< > indicates where to say a number or stored nametag.

[ ] denotes an optional word, e.g. 'VOICE [PLAY] DIRECTORY' can be given as 'VOICE DIRECTORY', or 'VOICE PLAY DIRECTORY'.

(front use only) – indicates this command is not available to rear occupants.

### General commands

- HELP
- VOICE HELP
  - Lists all voice command help messages available.
- VOICE MEMORY HELP (front use only)
- VOICE FEEDBACK (ON/OFF)
- PHONE CONFIRMATION (ON/OFF)
  - Switches on or off the system confirmation prompt before making a call when using the PHONE DIAL or PHONE MEMORY DIAL command.
- VOICE [PLAY] DIRECTORY (front use only)
- VOICE DELETE MEMORY (A/B) (front use only)
- VOICE DELETE DIRECTORY (front use only).



# JaguarVoice

---

## Radio commands

- RADIO PLAY or RADIO ON  
Turns the sound system on.
- RADIO OFF  
Turns the sound system off. Use this command to turn off the CD or CD changer.
- RADIO SEEK [UP]
- RADIO SEEK DOWN
- RADIO TUNE <frequency> [MEDIUM WAVE/LONG WAVE/FM]  
Tunes to the frequency given in the command.  
See 'HOW TO SAY NUMBERS', page 317.  
(The radio will not respond to Long Wave commands in Australia and New Zealand.)
- RADIO TUNE <nametag>
- [RADIO] [TUNE] PRESET <preset number>  
Selects the stored station corresponding to the preset number (1 to 9) given in the command.
- [RADIO] [TUNE] [BAND] (MEDIUM WAVE/LONG WAVE/FM)
- RADIO TRAFFIC INFO (ON/OFF)  
Turns on or off the Traffic Announcement (TA) feature.
- RADIO STORE NAME  
Stores the currently selected station, with a nametag of your choice. See 'Storing a nametag to this station', page 313. A total of 20 nametags can be stored.
- [RADIO] STORE PRESET <preset number>  
Stores the currently selected station to the preset given in the command.

**Note:** The sound system must be in radio mode before giving the 'RADIO STORE NAME' or 'RADIO STORE PRESET' command.

- RADIO AUTOSTORE
- RADIO DELETE <nametag>
- RADIO DELETE DIRECTORY  
Deletes all currently stored radio nametags.
- RADIO [PLAY] DIRECTORY
- RADIO HELP
- RADIO MEMORY HELP

## Single CD commands

- CD PLAY or CD ON
- CD [PLAY] TRACK <track number>  
See 'HOW TO SAY NUMBERS', page 317.
- CD MIX TRACKS  
This will play the tracks of the current disc in a random order.
- CD MIX OFF
- CD HELP

## CD changer commands

- CHANGER PLAY or CHANGER ON
- [CHANGER] [PLAY] DISC <disc number>
- [CHANGER] [PLAY] TRACK <track number>  
See 'HOW TO SAY NUMBERS', page 317.
- [CHANGER] [PLAY] DISC <disc number> TRACK <track number>
- CHANGER MIX TRACKS  
This will play the tracks of the current disc in a random order.
- CHANGER MIX ALL  
This will play all the tracks and discs within the CD changer in a random order.

# JaguarVoice

---

- CHANGER MIX OFF
- CHANGER HELP

## Generic track commands

These commands play the current or previous CD, MD or Changer.

- [PLAY] TRACK <track number>
- MIX TRACKS
- MIX OFF

## Phone commands

**Note:** In noisy conditions, for example, in heavy rain or driving at high speed on a rough road surface, use the 'PHONE ENTER' command, entering the number in several groups for improved recognition.

- PHONE (ON/OFF)
- [PHONE] ENTER <2 – 16 phone digits>  
See 'HOW TO SAY NUMBERS', page 317.

The system responds to this command by repeating the phone number back to you and then giving you the options below.

Remember to press the voice button to continue with one of the options.

– <more digits>

– DIAL

– STORE (give a *nametag* when prompted as in RADIO STORE NAME, see 'Storing a *nametag* to this station', page 313.

– CORRECTION

– CANCEL

For help, see 'Entering a phone number', page 314.

A total of 40 *nametags* can be stored.

- (PHONE DIAL/DIAL) <phone number>  
See 'HOW TO SAY NUMBERS', page 317.
- [PHONE] REDIAL
- [PHONE] DIAL <nametag>

Calls the phone number stored with the *nametag* given.

- [PHONE] DIAL MEMORY <memory location number>

Calls the phone number stored in the phone memory location given.

See 'HOW TO SAY NUMBERS', page 317.

Memory numbers 1 – 100 refer to numbers stored in the phone memory and numbers 101 – 249 are numbers stored in the SIM card.

- PHONE STORE <phone number>

Allows you to store a *nametag* to the number given in the command.

The system will prompt you with 'NAME PLEASE', press and release the voice button and give a *nametag* of your choice, as in the RADIO STORE NAME. See 'Storing a *nametag* to this station', page 313.

A total of 40 phone *nametags* can be stored.

See 'HOW TO SAY NUMBERS', page 317.

See 'Nametags', page 315.

- PHONE [PLAY] DIRECTORY
- PHONE DELETE <nametag>
- PHONE DELETE DIRECTORY

Deletes all currently stored phone *nametags*.

This does not affect numbers stored in the phone memory.

- PHONE CONFIRMATION (ON/OFF)
- PHONE HELP
- PHONE MEMORY HELP

# JaguarVoice

---

## Note:

- When an outgoing phone call is terminated, the sound system will remain in phone mode. To change to another mode, give the appropriate voice command.
- The voice system is inactive while a phone call is in progress.

## Automatic climate control commands

- CLIMATE CONTROL ON
- CLIMATE CONTROL OFF
- [CLIMATE CONTROL] AUTOMATIC [ON]
- [CLIMATE CONTROL] TEMPERATURE <temperature> [DEGREES]

The temperature can be given in Celsius or Fahrenheit, in the range 17 to 31 degrees Celsius (61 to 89 degrees Fahrenheit), in increments of 0.5 degree Celsius (1.0 degree Fahrenheit).

See 'HOW TO SAY NUMBERS', page 317.

**Note:** Do not say the word 'Celsius' or 'Fahrenheit'.

- [CLIMATE CONTROL] TEMPERATURE (HIGH/LOW) (front use only)
- [CLIMATE CONTROL] RECIRC [ON] (front use only)

Recirculation mode, see 'AIR RECIRCULATION', page 150.

This command will not be executed if the climate control system is in defrost mode.

## Automatic climate control commands (continued)

- [CLIMATE CONTROL] BALANCE [ON]  
When the driver gives this command the temperature of all zones are set to the same as the driver's side temperature. When a rear occupant gives this command the temperature of both rear zones will be set to the same.
- [CLIMATE CONTROL] DEFROST [ON] (front use only).
- CLIMATE CONTROL HELP.
- REAR CLIMATE CONTROL OFF.
- [CLIMATE CONTROL] RECIRC [ON]  
Switches the climate control system to recirc mode. This command will be disabled if the climate control system is in defrost mode.

# JaguarVoice

---

## VOICE TRAINING

The voice system is able to interpret most English speakers without difficulty. If, however, you find that commands are sometimes not being recognised, you can train the voice system to recognise your voice. The voice system can be trained for two people using voice memories A and B.

After Voice Training, the system will automatically recognise the users whose voices are held in the voice memory. The system can still be used by other users, with no loss of recognition.

### Training procedure

Training can only be carried out whilst sitting in the driver's seat.

Give the command 'VOICE DIRECTORY', this will list the memories used and tell you if they are stored with a nametag.

If no memories are in use, either memory can be used.

If both memories are in use and you wish to overwrite one of the memories, select the memory you wish to overwrite.

- First, select which voice memory to train.
- Position the vehicle, with the sunroof and windows closed, in a reasonably quiet outdoor location.
- Sit in the driving seat with the engine running, the handbrake or Electric Parking Brake (EPB) on and the transmission in Park or Neutral.
- Press and release the MODE button on the radio (adjacent to the volume control). Mode level 1 will display. Press the MODE button repeatedly until 'ADV MODE N/Y' is displayed. Turn the volume control to select 'ADV MODE YES' Press the MODE button repeatedly until 'VOICE A' is displayed. To select 'VOICE B' press the MODE button again.
- With 'VOICE A' or 'VOICE B' displayed on the radio press the seek up control to start Voice Training. Once you have selected which memory to use, the system gives verbal instructions about the training procedure.
- Follow the instructions given by the system. See '*TRAINING COMMAND LIST*', page 323.
- To cancel Voice Training at any time press and hold the voice button for five seconds.

### Note:

- *Some of the phrases which the voice system asks you to repeat during voice training are not valid voice commands, these are used to collect specific phonetic phrases required by the system.*
- *If the user does not speak after a phrase prompt, the voice system will provide two reminder prompts then cancel Voice Training.*
- *The voice system turns off the phone whilst in training mode, so it will need to be turned on manually after Voice Training has finished.*

# JaguarVoice

---

## TRAINING COMMAND LIST

The 'sounds' of the following training commands are required for the voice system to 'learn', although some of the equipment (TV, navigation, telephone etc.) stated in the commands may not be fitted to a particular vehicle.

1. display select twilight colours
2. prefer toll roads
3. radio ten oh eight AM
4. store preset five
5. tune one oh five point two FM
6. telephone enter eight four six three seven
7. select one zero four point nine
8. CD changer play disc one track seventy six
9. climate temperature twenty five point oh degrees
10. radio one oh eight point zero
11. phone enter triple three treble zero
12. map traffic information off
13. voice guidance on
14. dial memory two hundred
15. teletext page eight four seven
16. radio tune thirteen ninety five AM
17. select fifteen eighty four medium wave
18. changer play CD six track sixty nine
19. navigation select zoom level eleven
20. telephone dial memory fifty two
21. climate control balance on
22. avoid major roads
23. map show complete route
24. navigation clear next waypoint
25. radio tune one oh seven point one FM
26. screen select automatic colours
27. repeat last instruction
28. phone enter gate double three one oh
29. TV channel down
30. television seek up
31. radio tune two sixteen long wave
32. select twelve thirty three medium wave
33. voice delete memory A
34. climate control seventeen point zero degrees
35. navigation show current position
36. CD changer play CD two track nineteen
37. map zoom out maximum

# JaguarVoice

---

## TROUBLESHOOTING ERROR MESSAGES

In addition to the voice command prompts given by the system, the following error messages may be displayed on the instrument pack display. Most of these messages are accompanied by an advisory double beep.

Voice Command Group	Message	Meaning
General	VOICE NOT READY	The voice system is initialising (when the starter switch is first turned on). It takes the voice system approximately ten seconds to initialise.
	NO SPEECH DETECTED	The voice system has not heard any speech. <ul style="list-style-type: none"><li>• Ensure that the command is given after the end of the beep.</li><li>• Ensure that the command is given within a maximum of five seconds from the end of the beep.</li></ul> <p><b>Note:</b> <i>Be sure you know what to say before pressing the Voice button.</i></p> If this error is displayed for all commands given this may indicate a fault with the microphone or microphone wiring, consult your Jaguar Dealer/Authorised Repairer for assistance.
	COMMAND CANCELLED	Displayed if the user cancels a voice session during the LISTENING period or another system interrupts the voice session (i.e. incoming phone call or radio traffic announcement).

# JaguarVoice

Voice Command Group	Message	Meaning
General (continued)	COMMAND NOT RECOGNISED	<p>The voice system has failed to recognise your command.</p> <ul style="list-style-type: none"><li>• Ensure that the command format is valid, see 'VOICE COMMAND LIST', page 318.</li><li>• Ensure that the command is given after the end of the beep.</li><li>• Look forward and speak clearly without pausing between words and at a level appropriate to the ambient noise level; imagine you are making a hands-free phone call.</li><li>• Ensure that the ambient noise level is not excessive, for example, windows open or demist on.</li></ul> <p><b>Note:</b> <i>If it is too noisy to use the phone, it is likely that voice commands will not be recognised.</i></p> <ul style="list-style-type: none"><li>• If optional words of the command have been omitted, then the command should be tried with these in place.</li><li>• If a number of commands have been given in rapid succession resulting in the message 'COMMAND NOT RECOGNISED' to be displayed, then allow the system to recover (approximately one minute) before trying the command again.</li><li>• If the system consistently fails to recognise commands, the voice training procedure should be carried out to improve the recognition response for the speaker.</li></ul>

# JaguarVoice

Voice Command Group	Message	Meaning
<b>Phone</b>	CONNECT PHONE TRY AGAIN	If the GSM phone is in its cradle but the voice system keeps saying 'dial not accepted, please connect phone and try again', then the phone handset may not be correctly attached to its storage cradle. Try re-attaching the phone handset. If the problem persists, the phone may be incorrectly reporting its cradle status. Try powering the phone handset off and on to resolve the issue.
<b>Voice Training</b>	SET HANDBRAKE TO CONTINUE	This text message is displayed with its associated verbal feedback when the EPB is released during voice training. To continue voice training the brake must be re-applied.
	VOICE TRAINING UNSUCCESSFUL	This text message is displayed with its associated verbal feedback if the voice system could not save the training model recorded. If this problem occurs, please turn the starter switch off, wait five seconds, and turn the starter switch back on. Please check that there is no abnormal/excessive noise entering the vehicle interior and try running the voice training procedure again. If the voice system continues to exhibit this error, consult your Jaguar Dealer for assistance.



# JaguarVoice

Voice Command Group	Message	Meaning
Nametags	RADIO NOT IN TUNER MODE	Displayed when the user tries to store a radio nametag and the radio has not been placed in tuner mode, for example playing a CD.
	NAMES TOO MUCH ALIKE	<ul style="list-style-type: none"> <li>This response will be received when storing a nametag if the nametag being given has already been stored. This can be confirmed by giving the RADIO DIRECTORY or PHONE DIRECTORY command.</li> <li>If this response is received and the nametag has not been used already, then it is too similar to an existing nametag or voice grammar and an alternative should be used.</li> </ul>
	SPOKE DURING LISTENING TONE	Displayed when user utters a radio or phone nametag while the beep is playing. Please wait for the end of the beep then say the nametag.
	DIRECTORY FULL	The user has tried to add a nametag to a directory that is full. The voice system can store up to 40 phone and 20 radio nametags.
	DIRECTORY EMPTY	Displayed when a RADIO DIRECTORY, PHONE DIRECTORY or VOICE DIRECTORY command is given and no nametags have been stored in the associated directory.
	NAMETAG TOO LONG	The nametag given is too short (so as not to mistake the nametag for inadvertent noise). If you experience this error please provide a longer nametag.
	STORE CANCELLED	Displayed and associated verbal response is provided when a nametag storage session is cancelled by the user.

# JaguarVoice

---

<b>Voice Command Group</b>	<b>Message</b>	<b>Meaning</b>
Nametags (continued)	STORE FAILED	Displayed when the voice system fails to store a nametag.  Possible reasons could be that the nametag is too long or there is too much noise. Try the command again. If the error persists, try storing the nametag under quiet conditions such as with the vehicle parked and the windows closed.

# Index

## A

Address book	307
Airbag service information	48
Airbags	42
Alarms and audible signals	35
Alternator	214
Anti-freeze	210
Anti-lock braking system (ABS)	126
Audible warnings	85
Audio controls	268, 276
Steering wheel controls	269
Audio system	
audio setup	262
CD changer	285
CD control	282
change audio source	264
digital signal processing	263
radio data systems (RDS)	253
radio operation	261
single CD player operation	282
steering wheel controls	252
Automatic climate control with LCD screen	147
Automatic transmission	120
Automatic mode	120
Electronic gear change strategies	122
gear selector positions	123
gearshift interlock	123
kickdown	124
limp-home mode	124
Sport mode and CommandShift™	121
Auxiliary heater	145

## B

Battery	
charging	214
lead disconnect/reconnect	37
warnings	212
Bluetooth description	289
Bonnet release	199
Brakes	126
emergency brake assist (EBA)	127

Bulb renewal	181
front direction indicator	183
front fog lamp	184
front parking side lamp	183
headlamp dip beam	182
headlamp main beam	181
high-mounted stop lamp	186
number plate lamp	184
rear lamp - estate	185
rear lamp - saloon	185
side repeaters	182

## C

Call volume	289
Catalytic converters	142
Changing a phone number	306
Channel automatic tuning	270, 277
Channel options	270, 278
DAB search	272
Finding a channel	271
Finding an ensemble	271
Selecting a channel	278
Selecting a subchannel	278
Selecting an ensemble	278
Signal availability	279
Checking and top-up	204
clutch/brake fluid	207
engine coolant	209
engine oil	204
power steering fluid	206
windscreen washer fluid	208
Child and infant safety	49
Child safety	49
check list - ISOFIX	58
child restraints securing	52
ISOFIX child restraint system	54
ISOFIX restraint system	55
seating positioning	51
top tether anchorage	56
Child safety locks	33

# Index

- Climate control
  - general points . . . . . 144
  - recommended operation . . . . . 143
  - touch-screen
    - air conditioning . . . . . 163
    - AUTO mode . . . . . 158
    - blower mute . . . . . 164
    - blower speed . . . . . 163
    - Celsius/Fahrenheit selection . . . . . 160
    - climate options . . . . . 166
    - controls . . . . . 156
    - displays . . . . . 157
    - dual temperature zones . . . . . 159
    - external temperature . . . . . 160
    - heated screens and mirrors . . . . . 162
    - latched air recirculation . . . . . 161
    - manual air distribution . . . . . 164
    - ram air . . . . . 165
    - smog sensing . . . . . 166
    - switching off . . . . . 165
    - temperature selection . . . . . 159
    - timed air recirculation . . . . . 161
    - windscreen defrost/demist . . . . . 162
- Clock . . . . . 66
- Clock setting . . . . . 257
- Compact disc changer
  - CD check sequence . . . . . 285
  - CD selection . . . . . 286
  - CDC button . . . . . 286
  - display panel . . . . . 286
  - loading discs into the magazine . . . . . 285
  - mix . . . . . 286
  - operation . . . . . 285
  - pause . . . . . 287
  - repeat . . . . . 286
  - seek up and down . . . . . 286
- D**
- Declaration of conformity . . . . . 309
- Diesel
  - auxiliary heater . . . . . 145
- Diesel engines
  - running out of fuel . . . . . 141
- Diesel particulate filter (DPF) . . . . . 140
  - regeneration . . . . . 140
  - regeneration procedure . . . . . 141
  - warning indicators and messages . . . . . 140
- Display options
  - DAB radio text . . . . . 269
- Door locks and handles . . . . . 29
  - smart locking . . . . . 29
- Door window operation . . . . . 68
- DPF . . . . . 140
- DTMF tones . . . . . 306
- Dynamic stability control . . . . . 128
- E**
- Electric window operation . . . . . 68
- Electrical accessories . . . . . 227
- Emergency brake assist . . . . . 127
- Emergency starting . . . . . 168
- Engine block heater . . . . . 211
- Engine number . . . . . 18
- Exterior lighting . . . . . 94
  - auto headlamp levelling . . . . . 96
  - daylight running lamps . . . . . 95
  - direction indicators . . . . . 98
  - hazard warning . . . . . 97
  - headlamp convenience . . . . . 95
  - headlamp levelling . . . . . 96
  - rear fog lamps . . . . . 95
- F**
- Fire extinguisher . . . . . 132, 195
- First aid kit . . . . . 132
- Floor mat retention . . . . . 11
- Foreign travel . . . . . 132
- Fuel and refuelling . . . . . 136
- Fuel capacity . . . . . 137
- Fuel consumption . . . . . 241
- Fuel requirements . . . . . 138
  - diesel engines . . . . . 139
  - petrol engines . . . . . 138
- Fuel tank filling . . . . . 136
- Fuses and fuse boxes . . . . . 187
  - fuse box locations . . . . . 188
  - fuse renewing . . . . . 187

# Index

## G

- General driving information . . . . . 129
  - engine braking . . . . . 130
  - engine oil consumption . . . . . 131, 202
  - parking the vehicle . . . . . 131
  - running-in . . . . . 16
  - use of headlamps . . . . . 130
  - warming up . . . . . 129
- General information . . . . . 250
- Generator . . . . . 214

## H

- Handbrake . . . . . 111
- Hazard warning . . . . . 97
- Headlamp adjustment . . . . . 97
- Health and safety . . . . . 20
- Horn . . . . . 105

## I

- Inertia switch . . . . . 167
- Instruments . . . . . 78
  - engine temperature . . . . . 80
  - fuel level gauge . . . . . 79
  - odometer . . . . . 80
  - speedometer . . . . . 78
  - tachometer . . . . . 79
- Interior features . . . . . 112
  - cigar lighter and ashtray . . . . . 114
  - cubby box . . . . . 112
  - glove compartment . . . . . 114
  - rear centre armrest . . . . . 116
  - sliding armrest . . . . . 112
  - sun visors . . . . . 115
- Interior lighting
  - battery saver . . . . . 100
  - dimmer switch . . . . . 101
  - entry/exit . . . . . 99
  - reading/map lamps . . . . . 99
  - rear roof lamp . . . . . 100
- Introduction
  - audio systems . . . . . 243
  - automatic climate control . . . . . 243
  - in-car telephone . . . . . 244
  - JaguarVoice . . . . . 245
  - screen cleaning . . . . . 242

## J

- Jacking . . . . . 171
- Jaguar parts and accessories . . . . . 10
- JaguarVoice
  - command confirmation . . . . . 315
  - command list . . . . . 318
  - how to say numbers . . . . . 317
  - introduction . . . . . 311
  - language and accent . . . . . 311
  - nametags . . . . . 315
  - operating tips . . . . . 315
  - steering wheel voice switch . . . . . 312
  - training
    - training command list . . . . . 323
    - training procedure . . . . . 322
  - trouble-shooting error messages . . . . . 324
  - useful notes . . . . . 316
  - using the system . . . . . 312
  - voice system prompts . . . . . 315
  - volume level adjustment . . . . . 316

## K

- Key transmitter . . . . . 25
  - battery replacement . . . . . 27
- Keys . . . . . 25

## L

- Lighting
  - Exterior . . . . . 94
- Locking wheel nuts . . . . . 173
- Luggage compartment . . . . . 73
  - estate luggage cover . . . . . 76
  - estate luggage load net . . . . . 77
  - tie-down loops, saloon . . . . . 73, 74
  - wagon luggage load net . . . . . 77

## M

- Maintenance . . . . . 197
  - general precautions . . . . . 197, 199
  - protect the environment . . . . . 198
  - regular checks . . . . . 201
  - regular servicing . . . . . 197
- Manual transmission . . . . . 125
- Message centre . . . . . 86
  - messages . . . . . 87

# Index

- Mirrors  
  door . . . . . 71  
  electrochromic . . . . . 72  
  heating . . . . . 71  
  interior rear view . . . . . 72  
  power fold back . . . . . 71
- Mobile/portable telephones . . . . . 12
- O**
- Occupancy sensing . . . . . 46
- Occupant restraints . . . . . 42
- Owner general information . . . . . 9
- P**
- Pairing . . . . . 293
- Parking assist . . . . . 102
- Phone book . . . . . 307
- Preset buttons . . . . . 273, 279  
  Recalling a preset channel . . . . . 274, 279  
  Storing channels as presets . . . . . 273, 279
- Protect the environment . . . . . 12
- R**
- Radio  
  auto memory . . . . . 259, 265  
  automatic volume control . . . . . 257  
  band switch . . . . . 258  
  change audio source . . . . . 258  
  digital signal processing . . . . . 257  
  display panel . . . . . 257  
  mode level 1 . . . . . 257  
  ON/OFF and volume . . . . . 257  
  presetting memorised stations . . . . . 258  
  priority programme type (PPTY) . . . . . 254  
  programme type (PTY) . . . . . 254  
  RDS operation . . . . . 254  
  RDS trouble-shooting guide . . . . . 256  
  reception . . . . . 253  
  seek and manual tuning . . . . . 259  
  source tone memory . . . . . 258  
  TA operation . . . . . 254
- Radio frequency approval . . . . . 27
- Radio set up . . . . . 259
- Rain sensitive wiper control . . . . . 108
- Rear seat back fold down . . . . . 75
- Regular checks . . . . . 201
- Regular servicing . . . . . 14
- Reverse aid . . . . . 102
- Roof-rack . . . . . 132
- Roof-rack  
  capacity . . . . . 237
- Running-in . . . . . 16
- S**
- Seat adjustment . . . . . 60  
  front seats - electrical . . . . . 62  
  front seats - electrical with memory . . . . . 63  
  head restraints . . . . . 61
- Seat belts . . . . . 38
- Seat heaters . . . . . 65
- Security code number . . . . . 250
- Security features . . . . . 36  
  battery reconnection . . . . . 37  
  inclination (tilt) sensing . . . . . 36  
  intrusion sensing . . . . . 36  
  panic alarm . . . . . 37
- Selecting DAB . . . . . 277
- Settings . . . . . 274  
  Announcements . . . . . 274  
  DAB country . . . . . 274  
  DAB format . . . . . 275
- Single CD player  
  CD button . . . . . 282  
  display panel . . . . . 282  
  eject and CD-in indicator . . . . . 282  
  mix . . . . . 282  
  repeat . . . . . 282  
  seek up and down . . . . . 282
- Sitting in the correct position . . . . . 60
- Sport mode . . . . . 124
- Starter switch . . . . . 22  
  gearshift interlock . . . . . 23  
  steering column lock . . . . . 23  
  to remove the key . . . . . 22
- Starting/stopping the vehicle . . . . . 117  
  before starting . . . . . 117  
  starting a diesel engine . . . . . 118  
  starting a petrol engine . . . . . 117
- Steering column adjustment . . . . . 67
- Steering wheel controls . . . . . 293
- Sunroof . . . . . 106

# Index

## T

Telephone	289
PIN	306
Safety	291
Standard	298
Making a call	301
Memory recall dialling	302
Receiving a call	300
Rejecting a call	300
System overview	289
Touch-screen	303
Making a call	303
Receiving a call	304
Temporary spare wheel	172
Touch-screen	242
Touch-screen controls	
Last number redial	305
List by name	306
Location number	305
Name entry	306
Touch-screen display	246
brightness/contrast	248
menu	247
system setup	248
volume preset	247
Touring	132
Touring headlamp adjustment	97
Towbar fixing points	135
Towing a caravan or trailer	134
Towing a trailer	134
Towing eye	179
Trailer weights	237
Tyres	218
damage	221
pressures	219
recommended fitment	239
renewal	218
repair	221
snow chains	223
wear	221
winter (snow) tyres	222

## V

Vehicle	
recovery	177
transporting	178
Vehicle care	224
alloy road wheels	226
automatic car wash	225
carpets	224
cloth upholstery	224
exterior care	225
glass surfaces	225
interior care	224
leather upholstery	13
paintwork	226
removing grease or tar	225
removing stains	224
underbonnet cleaning	226
washing	225
Vehicle data	
dimensions	238
engine	228
recommended tyre fitment	239
roof load and trailer weights	237
weights	229
Vehicle identification	17
Vehicle locking and unlocking	30
Vehicle recovery	177
towing eye	179
transporting	178
Vehicle security	24
alarms and audible signals	35
child safety locks	33
door locks and handles	29
key transmitter	25
keys	25
luggage compartment	34
security light	24
Voice activation	290
Volume	289
<b>W</b>	
Warning indicators	81
Warning triangle	133
Warnings, cautions and notes	9
Weights	229

# Index

---

Wheel changing . . . . .	174
Wheel changing and jacking . . . . .	171
Wheel/tyre data . . . . .	239, 240
Wind resonance . . . . .	69
Window operation . . . . .	68
anti-trap feature . . . . .	69
Window tinting . . . . .	11
Windscreen	
wipers/washers . . . . .	108
Winter driving . . . . .	132
Wiper blades . . . . .	216